

BOOK No. 68/152

PRICE 2/-

**INSTRUCTION BOOK
AND SPARE PARTS LIST**

Lister

TYPES D & DK

**PETROL AND PETROL-
PARAFFIN ENGINES**

**R. A. LISTER & CO. LTD.,
DURSLEY · GLOUCESTERSHIRE
ENGLAND**

INSTALLATION. Fix the engine level and accessible. Arrange cooling tank with the bottom pipe level and the top pipe a continuous upward slope. If a longer exhaust pipe is necessary use $1\frac{1}{4}$ " bore pipe or larger and turn downward from the engine.

COOLING. Fill water tank, radiator or hopper. If engine is tank cooled see that three-way cock is turned so that water can flow from tank into engine cylinder jacket. Add water as necessary to maintain water level.

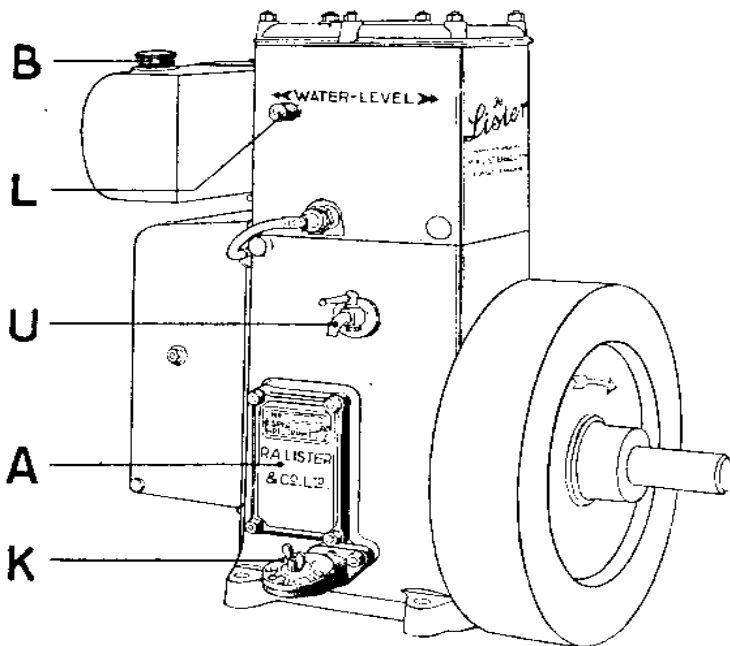

EXHAUST. Should be colourless. Black smoke indicates too much fuel, blue smoke too much lubricating oil. Clean out the exhaust pipes when decarbonising.

* **LUBRICATION** For petrol engines use Listroil L2 in winter and L3 in summer. For petrol-paraffin engines always use Listroil L3.

Where Listroil is not available, use SAE 30 oil in Temperate Climate and SAE 40 oil in Tropical Climate.

Every three months drain off lubricating oil through plug 'F.' Remove door 'A' and clean out crankcase. Do this every month if engine is running on paraffin.

Always keep the engine sump, Lubricator 'W' and Greaser 'L' filled.

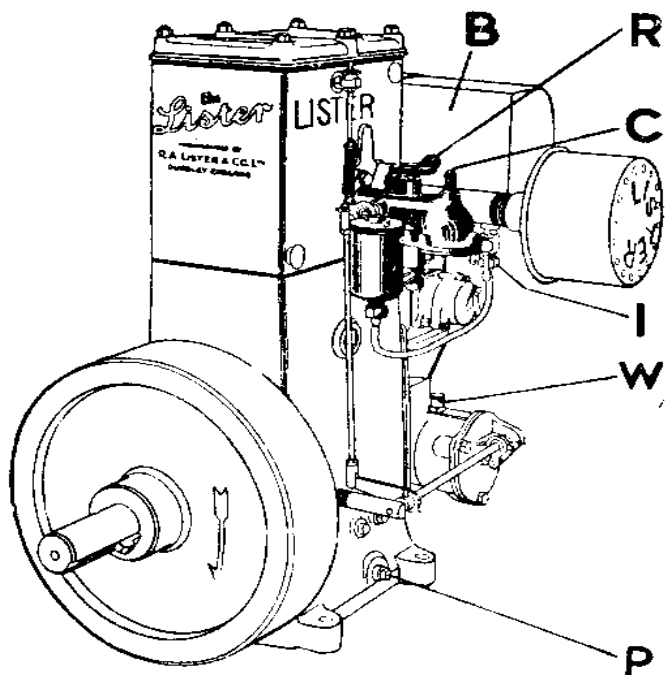

STARTING. New or Overhauled Engine. Remove door 'A' and filler cap 'K' pour lubricating oil * into crankcase until the filler is full. Fill the timing gear trough through hole on the left inside crankcase. Turn Crank to front end of Splash Tray and pour oil over Big End Bearing, particularly into two holes in Connecting Rod Boss, rocking the Shaft at the same time. This will provide the initial lubrication for the Big End Bearing. Further oil as necessary should be added through filler 'K' and oil should always be visible in this filler. Remove plug marked

'Oil' under the magneto also the lubricator 'W' and pour a teaspoonful of oil into each hole. Fill lubricator 'W' with oil, fill greaser 'L' with brown grease giving it a few turns. Fill fuel tank 'B' using a fine gauze strainer and see that ignition cable is connected to sparking plug.

TO START PETROL ENGINE. Turn on fuel tap 'I,' pull flywheel in opposite direction to arrow until compression is felt. Turn fuel regulator 'R' to start position, then while turning the starting handle place a finger on the Air valve 'C' to give the necessary rich mixture. After the engine has started turn down the fuel regulator as far as possible without slowing the engine. Every notch reduces fuel consumption and carbon deposit.

TO START PETROL PARAFFIN ENGINE. Drain the float chamber by the small tap and turn fuel tap '1' to petrol and start as above. Allow to run for a few minutes on petrol to warm up before turning fuel tap to paraffin. If the engine misfires place finger on air valve 'C' to allow engine to pick up speed.

TO STOP. Turn fuel regulator down as far as it will go and turn off the fuel tap '1.' Always drain water from cylinder jacket through tap 'U' if there is a possibility of frost.

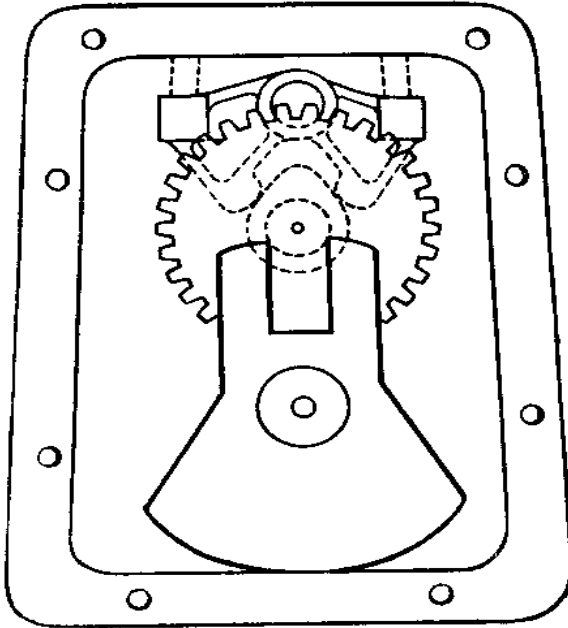

IGNITION AT FAULT. Clean sparking plug points and re-set gap to .020" and test. Use sparking plugs such as Lodge BBL or equivalent. If a good spark is not seen read magneto Instruction Book.

COMPRESSION. Loss of compression may be due to a valve sticking open or carbon on the valve seat. Pour a little paraffin around each valve stem. Compress each valve spring in turn with a screwdriver or suitable tool and slip it off allowing the valve to close with a snap. Alternatively the loss of compression may be due to no tappet clearance, piston rings stuck in grooves, cylinder worn or cylinder head nuts slack.

KNOCKING. May be caused by worn bearings, carbon deposit on the piston and cylinder head, overheating, overload, pre-ignition or loose flywheel.

DECARBONISING. This is recommended every three months. Drain water system, remove top covers, sparking plug and radiator fan (if fitted), disconnect throttle rod and fuel pipe. Slide out rocker shaft, removing rockers, push rods and valve stem caps. Remove nuts and washers which secure the cylinder head and lift slightly, free gasket with a thin bladed knife then lift off. Remove five nuts holding main bearing housing to the crankcase. Crankshaft, flywheel and housing can be removed, while supporting the piston and connecting rod, which may then be withdrawn through the top of the cylinder.

Remove all carbon, grind in valves if pitted and replace all parts. Fit the flat side of the connecting rod next to the crank web. The cylinder gasket if damaged must be renewed. Tighten cylinder head nuts evenly and adjust tappet clearance to .031" when cold. After running engine, retighten cylinder head nuts and check tappet clearance.

TIMING VALVES. Turn crankshaft to T.D.C., assemble timing case with cam at the top position as illustrated, the timing case may then be bolted to the crankcase.

If the timing case has been dismantled, turn camshaft with cam at the top, turn trailing shaft with fork at the top and engage gears. Fit spiral gear to end of trailing shaft.

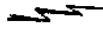
TIMING IGNITION. Turn flywheel until ignition mark  on rim is at the top. Loosen magneto sprocket and turn magneto spindle in the normal direction until the contacts just commence to separate; push the sprocket back on the spindle and tighten nut.

SPARE PARTS LIST

When ordering always give engine and specification numbers, description of part, and part number.

This list is subject to revision without notice.

1 Complete set of Joints for "D" Type Petrol Engines
(ordering Ref. List SP 274) comprises:—

Description	Material.	Part No.	Description	Material.	Part No.
1. Joint—Gov. Casing End Cover Paper	D149	1. Joint—Sparking Plug Copper	291/2265*
1. " Water Jacket Drain Tap Fibre	5197	1. " Starting Handle Bracket Paper	D80
1. " Float Chamber Fixing Plug Fibre	5197	1. " Timing Case Paper	D90
1. " Petrol Tank Supply Tap Fibre	5197	1. " Petrol Tank Strainer Fibre	12406
1. " Timing Case Oiling Plug Fibre	5197*			
2. " Fan Pulley Grease Plug (Rad. Co. only)	Fibre	5197			
1. " Float Chamber to Carburettor ...	Fibre	D320			
1. " Carburettor Flange Cork	D198*			
1. " Crankcase Door Fibre	D98			
1. " Water Jacket Plug Fibre	3306			
1. " Oil Filler Fibre	D247			
1. " Main Bearing Housing Paper	D87			
1. " Cylinder Head C & A	D91*			
1. " " Valve Rocker Cover	Fibre	D88*			

* Joints marked thus—for Decarbonising Only.
1 Complete set of Joints for 'D' Type Paraffin Engines, comprises parts as List SP 274 together with:—

Description

1. Joint—Float Chamber Drain Tap Fibre	12420
1. " Vaporiser to Cylinder Asbestos	1/1066
1. " Paraffin Tank Strainer Fibre	12406
1. " " Supply Tap Fibre	5197

OVERSIZE PARTS.

Pistons, Piston Rings and Cylinders (Crankcases) can be supplied: .010", .020" and .040" oversize.

STANDARD ROTATION.—When viewing the Engine from Starting Handle end, Starting Handle turns clockwise and Flywheel rotates in the opposite direction.

Reverse rotation can be supplied to order, in which case the letter "R" will be added to the Engine Specification No. stamped on the number plate.

e.g. 1½ HP Hopper Cooled Engine Clockwise Rotation Spec. 27DH.

1½ HP Hopper Cooled Engine Anti-clockwise Rotation Spec. 27DHR.

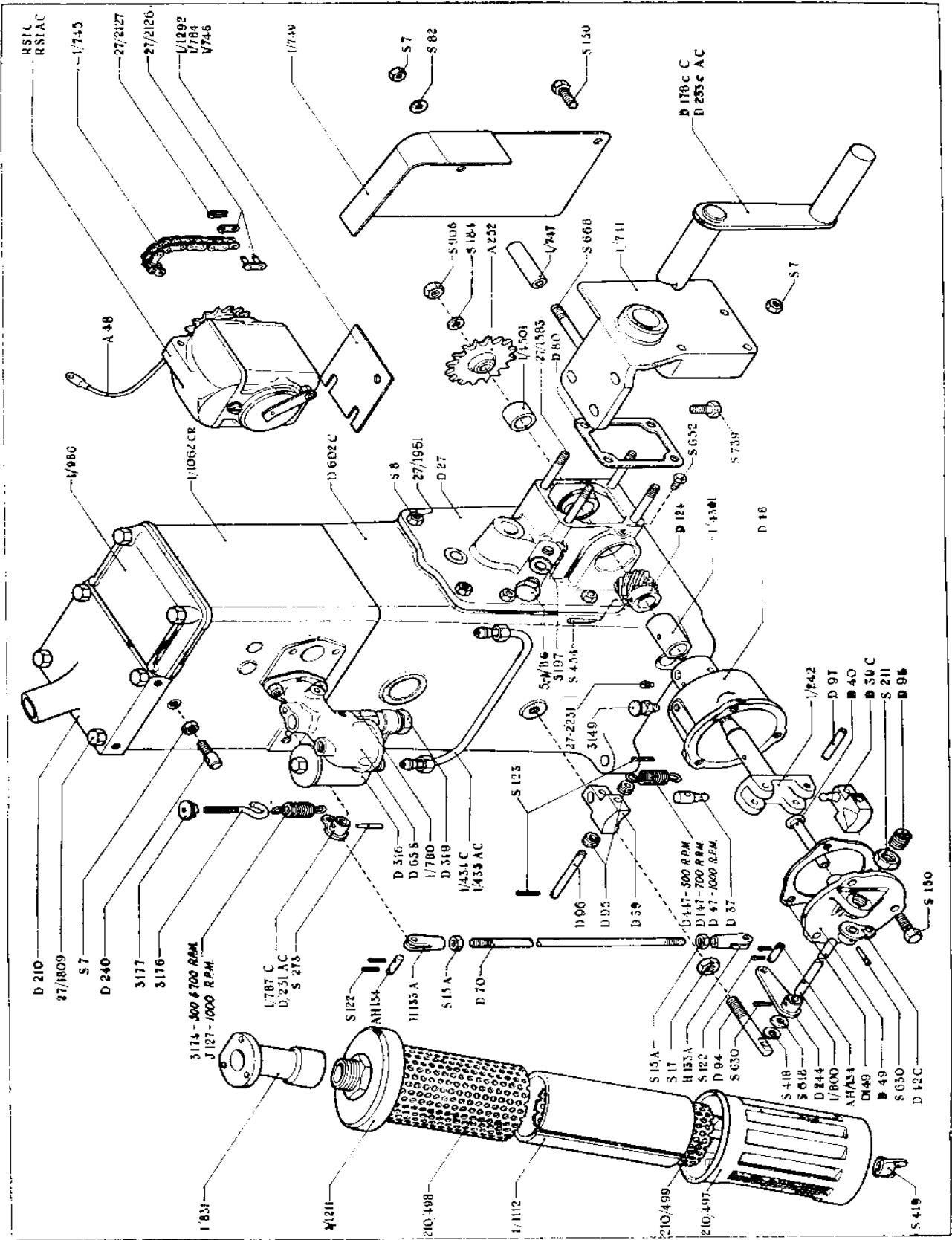

PLATE 1

PLATE 1

FOR ILLUSTRATION OF THESE PARTS REFER TO PAGE 4

	Order Part No.	No.		Order Part No.	No.
AIR FILTER (Felt pattern Lister) Assembly	1/830c	1	Governor Rod bare, C. or A.C.	1/800	1
Connection on Carburettor	1/831	1	Lever Governor End comprising Lever D42,	D42C	1
Felt Sleeve for Filter	1/1112	1	Roller 3172, Pin D107	D244	1
			Lever Crankcase End	S630	2
GOVERNOR for 700 R.P.M.	D267/3	1	" Taper Pin (Size 1)	D93	1
Complete for 1000/1250 R.P.M.	D268/3	1	Rod Adjustable Support on End Cover	S211	1
(Comprising the following parts):			" Lock Nut	D94	1
Casing with Bush 1/4301	D48B	1	" Support (fixed) on Crankcase	S17	1
Bush long	1/4301	1	Lock Nut for fixed Support	S418	1
" short	1/4501	1	Spring Washer for Governor Rod	S618	2
Casing Lubricator	3149	1	Plain	3174	1
Casing End Cover	D49	1	Outside Spring for 700 R.P.M.	J127	1
Joint for "	D149	1	" " " 1000 R.P.M.	T192	1
Set Screw "	S150	3	" " " 1100 to 1250 R.P.M.	3176	1
Governor Shaft	1/242	1	Spring Adjusting Hook 3/16" Whit.	3177	1
Spiral Gear on Governor Shaft	D124	1	" Nut	D70c	1
Taper Pin for Spiral Gear (No. 1)	S454	1	Throttle Connecting Rod complete	H133A	2
Governor Weights 500/1250 R.P.M.	D39c	2	" " " Fork	S15A	2
With Operating Pins			" " " Lock Nut	AH134	2
Weight Operating Pin	D37	2	" " " Split Pin	S122	4
Weight Spring	D447	2			
" Spindle	D147	2	MAGNETO (R.S.I.) Type.		
" Spring Pin	D47	2	Magneto for R.H. Starting Engines, Clock-		
" Roller	D97	2	wise		
" Pin for Roller Spring Pin	D96	2	Magneto for L.H. Starting Engines, Anti-		
Governor Push Rod	D95	4	clockwise		
Dowel Screw for Casing	S123	4	Magneto Top Cover	457, 634	1
Taper Reamer for No 1 Taper Pin	D40	1	Contact Set	457, 525	1
	S652	1	Coil	458, 137	1
	S751	1	Condenser	457, 524	1
			Contact Breaker Cover	457, 489	1
GOVERNOR FITTINGS			Spring Clip and Pin Assembly for do.	457, 491	1
Governor Rod c/w Levers. (Clockwise	1/840	1	Screwdriver and Points Gauge	27-1922	1
Petrol) (Anticlock			Magneto Sprocket (on Magneto)	A252	1
Petrol) (Clockwise	1/841	1	Driving Sprocket	A252	1
Paraffin)			Washer for "	S184	1
(Anticlock	1/841	1	Nut	S906	1
Paraffin)			Magneto Driving Chain, 44 Links	1/745	1

	Order Part No.	No.		Order Part No.	No.
Connecting Link for Chain	27-2126	1	SPANNERS		
Spring Clip for Connecting Link	27-2127	1	Spanner 3/16" x 1/4"	S323	1
Magneto Chain Guard	1/749	1	5/16" x 3/8"	S151	1
Distance Piece for Chain Guard	1/747	1	Box Spanner for Sparking Plug	3352	1
Stud	S668	1	" " Cylinder Head Nuts	D12	1
Washer	S82	3			
Nut	S7	1	SPARKING PLUG		
Set Screw	S150	1	Sparking Plug Lodge B.B.L.	A97	1
Shim for Adjustment of Chain	1/746	—	" " Joint	291-2265	1
" "	1/784	—			
" "	1/1292	—	WATER TANK AND FITTINGS		
Magneto Cable (with Brass End 3244)	A48/13	1	Water Tank 24 Gall. (temp.) 16" x 33"	A405	1
Bracket for Magneto and Starting Handle	1/741	1	" " 50 Gall. (tropical) 23" x 33"	3405	1
Set Screw—Magneto to Bracket	S739	3	3/4" 3-Way Cock	S386	1
			3/4" Pipe 2" long. Screwed one end	S712	3
STARTING HANDLE			3/4" Nipple (Plain)	S373	1
Starting Handle complete for standard (Rt. Hand) Rotation — comprising: Clutch D177, Tube D178, Spindle D179 and Crank D180	D178c	1	Hose Pipe 6" long 1" Bore (Top)	27/2353	1
Starting Handle complete for reversed (Left Hand) Rotation — comprising: Clutch D233, Tube D178, Spindle D179, Crank D180	D233c	1	" " 4" long 1" Bore (Bottom)	27/2339	1
Starting Handle Bracket	D80	1	" " Clips for 1" Bore Hose	H95	4
" " Nut	S7	4	1"-3/4" Reducing Bush (Temperate)	S376	2
			1"-3/4" " (Tropical)	S376	3
MISCELLANEOUS.			3" Spring Bend 120° Scr. one end (Bottom)	27/2354	1
INSTRUCTION and Spare Parts Book	Book 68	1	3" " 150" " (Top)	27/2352	1
JOINTS—Complete Set	As List No. SP274	—	Thermostat	8-2-181	1
			" " For D.K.	27/1756	2
			1 1/4" Bore Hose 6" long	3404	4
			Clips for ditto	S174	1
			1" Spring Bend 120°	S244	1
			1" " 150°	27/2353	2
			1" Bore Hose 6" long		

PLATE 2

FOR ILLUSTRATION OF THESE PARTS REFER TO PAGE 7

	Order Part No.	No.		Order Part No.	No.
CARBURETTOR, Complete with Float Chamber.					
For Clockwise Petrol Engine ..	1/802	—	Throttle Lever Taper Pin (No. 0) ..	S273	1
" Anticlock ..	1/804	—	Float Chamber complete ..	D316	1
" Clockwise Paraffin Engine ..	1/1252	—	" (Bare) ..	64/154L	1
" Anticlock ..	1/1254	—	" Cover c/w Tickler and Lock-screw	14/208	1
Comprising the following parts:			" Cover (Bare) ..	14/011	1
Carburettor Body (bare) ..	D65s	1	" Locking Screw ..	14/021	1
Air Valve ..	D109	1	" Needle ..	14/024	1
" Spring ..	D100	1	" Tickler with Spring and Split Pin ..	14/031/	1
" Adjuster ..	A189	1	Float ..	032 033	1
" Lock Nut ..	S583	1	Chamber Fixing Plug ..	14/015	1
" Plate (seat) ..	A79	1	" " " " Joint ..	D319	1
" Screws ..	27/1746	3	" " " " Paraffin ..	5197	1
" Studs (for Air Cleaner fitting) ..	27/1961	3	" " " " Engine ..	D319K	1
" Nuts (for Air Cleaner fitting) ..	S8	3	Drain Tap ..	301/471	1
" Spring Washer (for Air Cleaner fitting) ..	S451	3	" Joint Washer ..	12420	1
Choke Tube ..	D170	1	Float Chamber Joint Washer ..	D320	1
Petrol Regulator with Head ..	1/1282	1	Set Screw for fixing Carburettor ..	S150	2
" Bush ..	3469	1	Carburettor Flange Joint ..	D198	1
" Plunger ..	1/1285	1	Taper Reamer for size 0 Taper Pin ..	S750	1
" Spring ..	3458	1	Special Parts on Paraffin Engine only:—		
Jet ..	1/780	1	Vaporiser ..	1/1041	1
" Locking Screw ..	S607	1	" Joint ..	1/1066	1
Throttle Plate ..	D68	1	Stud for Vaporiser and Carburettor ..	27/1840	2
" Screw ..	S543	2	" Exhaust Flange ..	27/1940	2
" Spring Washer ..	S1129	2	Nuts " Studs 5/16" Whit. ..	S7	4
" Spindle ..	D66	1	Spring Washers for Exhaust Flange ..	S413	2
Lever—For R.H. Rotation Petrol Engine ..	1/787	1	Vaporiser Cover for Radiator Cooled only ..	1/1064	1
" for L.H. Rotation Petrol Engine ..	D231	1			
" for R.H. Rotation Petrol-Paraffin Engine ..	D231	—	CYLINDER HEAD		
" for L.H. Rotation Petrol-Paraffin Engine ..	1/787	—	Cylinder Head with the following fittings		
			only ..	1/1062s	1
			Stud for Fuel Tank Strap ..	S37	2
			Valve Guide ..	D310	2
			Spring Anchor Pin (Petrol) ..	D240	1
			" " " " (Paraffin) ..	1/1065	1
			" " " " Nut ..	S7	1

	Order Part No.	No.		Order Part No.	No.
CYLINDER HEAD with the above fittings and the following parts:			Grub Screw for Radiator Support Boss ..	3104	1
Inlet Valve	1/1062c	1	Cylinder Head Water Jacket Cover Set Screw	27/1809	6
Exhaust	D155IN	1	Plug (when Radiator not fitted)	27/1968	1
Valve End Cap	D255EX	1			
" Spring	D161	2			
" Carrier	D323	2			
" Cotter	D312	2			
" Cotter	D139	2			
CYLINDER HEAD with Valves and the following valve rocker parts:			FUEL TANK AND FITTINGS		
Valve Rocker, with Bush D64 and Striking Pin	1/1062CR	1	Fuel Tank	1/1059	1
Bush for Valve Rocker	D158c	2	" Filler Cap	27-3825	2
Valve Rocker Adjusting Screw	D64	2	" Felt Pad	AT268	2
" " Lock Nut	D60	2	" Strap	1/286	2
" " Shaft with End Plug	S714	2	" Set Screw	S150	2
" " End Plug	D153	1	" Spring Washer	S413	2
" " Grease Cup	D152	1	" Nut	S7	2
" " Fixing Set Pin	S606	1	" Strainer	1/1013c	1
" " Centre Collar	S150	1	" Joint	12406	1
" " End Collar	D313	1	" Funnel with Strainer	3298	1
	D314	2	For Petrol Engine only		
			Petrol Tap	D330	1
			" Joint	5197	1
			" Pipe with Unions		
			For Clockwise Rotation. D Type	1/434	1
			" Anti-clock	1/435	1
CYLINDER HEAD FITTINGS			For Petrol-Paraffin Engine only. From Engine No. 18704.		
Cylinder Head Gasket	D91	1	Petrol Container	205/876	1
Washer for holding down studs	S545	5	" Filler Cap	27-3825	1
7/16" Hex. Cap Nut for Cylinder Studs S535	S708	3	" Bracket	1/1240	2
7/16" Plain Nut S529	S5	2	" Bolt	S150	2
Valve Push Rod	D315C	2	" Nut	S7	2
Cylinder Exhaust Flange (for 1" bore pipe)	D302	1	" Washer	S413	2
Set Pin for	S66	2	" and Paraffin Taps	D330	2
Spring Washer	S413	2	" Tap Joints	5197	2
Cylinder Head Valve Rocker Cover	1/986	1	" Pipe		
" Water Jacket Cover (Tank Cooled Type)	D112	1	For Clockwise Rotation. DK Type	1/1229	1
Cylinder Head Cover (Hopper Cooled Type) (Rad. Cooled Type)	D112H	1	" Anti-clock	1/1231	1
" " Joint (combined)	D210	1	Paraffin Pipe		
" " Joint (combined)	D88	1	For Clockwise Rotation. DK Type	1/1230	1
Grub Screw for Anchor Pin hole (clockwise)	S607	1	" Anti-clock	1/1232	1
" " " (anti-clockwise)	S607	1	Fuel Two-Way Tap	D196	1
" " " clockwise)	S150	1			

PLATE 2 (Continued) FOR ILLUSTRATION OF THESE PARTS REFER TO PAGE 7

	Order Part No.	No.		Order Part No.	No.
RADIATOR			Fan Pulley Ball Bearing (large) LS7H ..	210 326	1
Radiator for Temperate Climate ..	1/1022	1	Thrust Tube for Ball Bearing (small) LS5H ..	*101/206	1
" " Tropical ..	105/484	1	Taper Pin for do. No. 1 x 1" ..	*F211	1
" " Filler Cap ..	10/7/106	1	Grease Plug for Pulley ..	S630	1
" " Cover ..	1/676	1	Joint Washer for " ..	*5-1/B6	2
Water Pipe 1" x 2 1/2" long S.I.E. ..	S255	1	Fan Pulley Thrust Plate ..	*F212	2
Hose Connection 2 3/4" long x 1 1/4" Bore ..	S733	2	Set Screws Fan Lever to Cylinder Head ..	S203	1
" " Clip ..	3404	4	Fan Lever with Spindle F210 riveted in ..	*D675C	2
Radiator Support (Top) ..	1/677	2	Plain Washers ..	S184	1
" " Support (Bottom) ..	1/678	2	Set Screws Dust Cover to Fan Pulley ..	S203	2
Set Screw Supports to Engine ..	S739	6	Fan Belt (V Type No. 46A) ..	F225	1
3/8" Plain Washer for ditto ..	S184	10	Drain Tap ..	D610	1
Set Screw Supports to Radiator ..	S901	4	" " Joint Washer ..	5197	2
5/16" Plain Washer for ditto ..	S82	4	" " Adaptor ..	D236	1
			" " " Joint ..	3306	1
FAN PULLEY ASSEMBLY COMPLETE, F220			Flywheel Fan Pulley ..	F224	1
comprising parts marked *			" " Bolt ..	S201	3
Fan Blade Assembly complete R.H. rotation *F213		1	" " Spring Washer ..	S393	3
" " " " L.H. rotation *F217		1	" " Nut ..	S6	3
" " " " " " *F210		1	SILENCER		
Set Screws fan to pulley and thrust plate 8-1/E41		8	Silencer complete with 1" bore pipe D&DK	D301C	1
Spring Washers ..	S451	8	" " Pipe, 1" B.S.P. x 5 1/2" long ..	S1193	1
Fan Pulley ..	*F219	1	" " Flange ..	D302	1

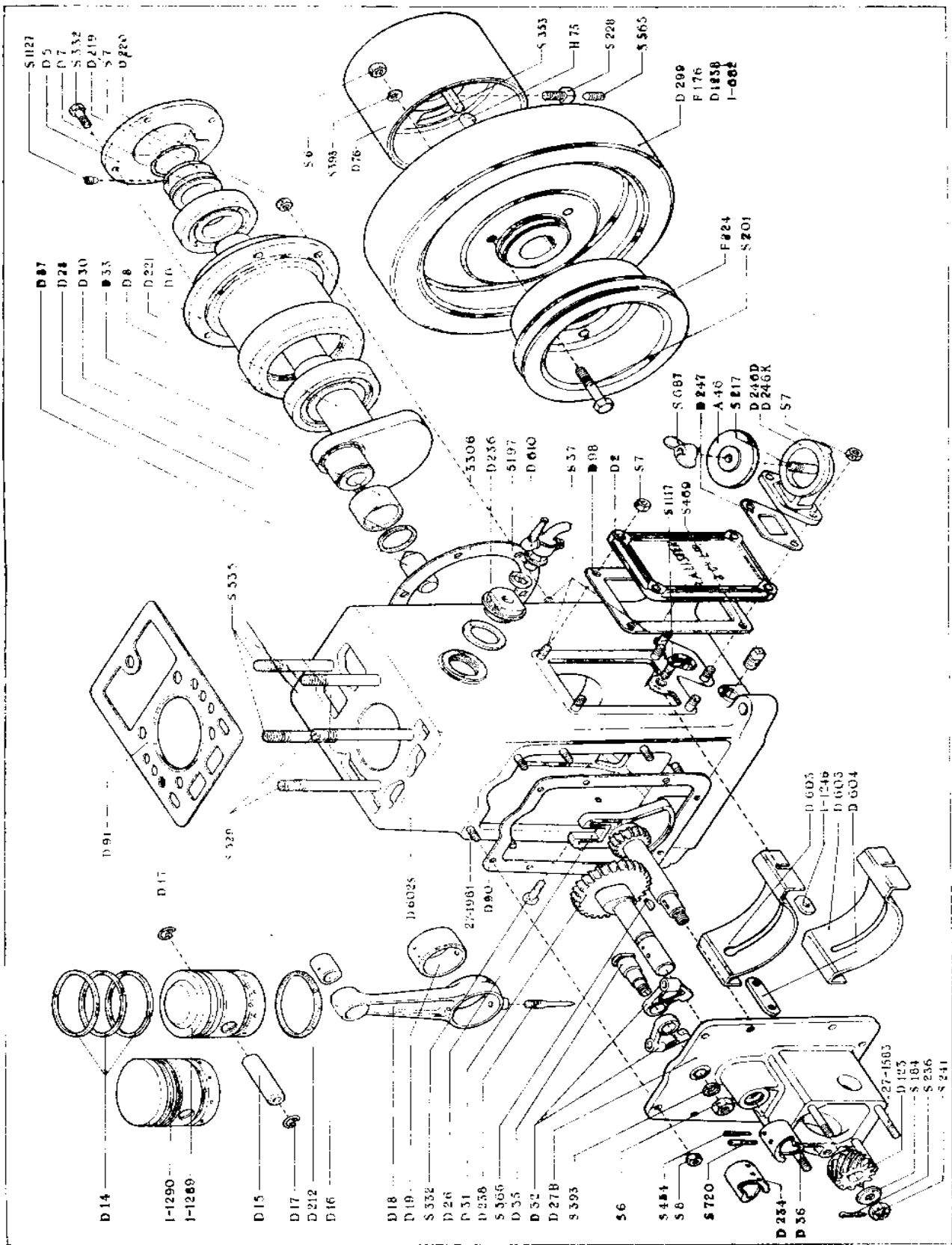
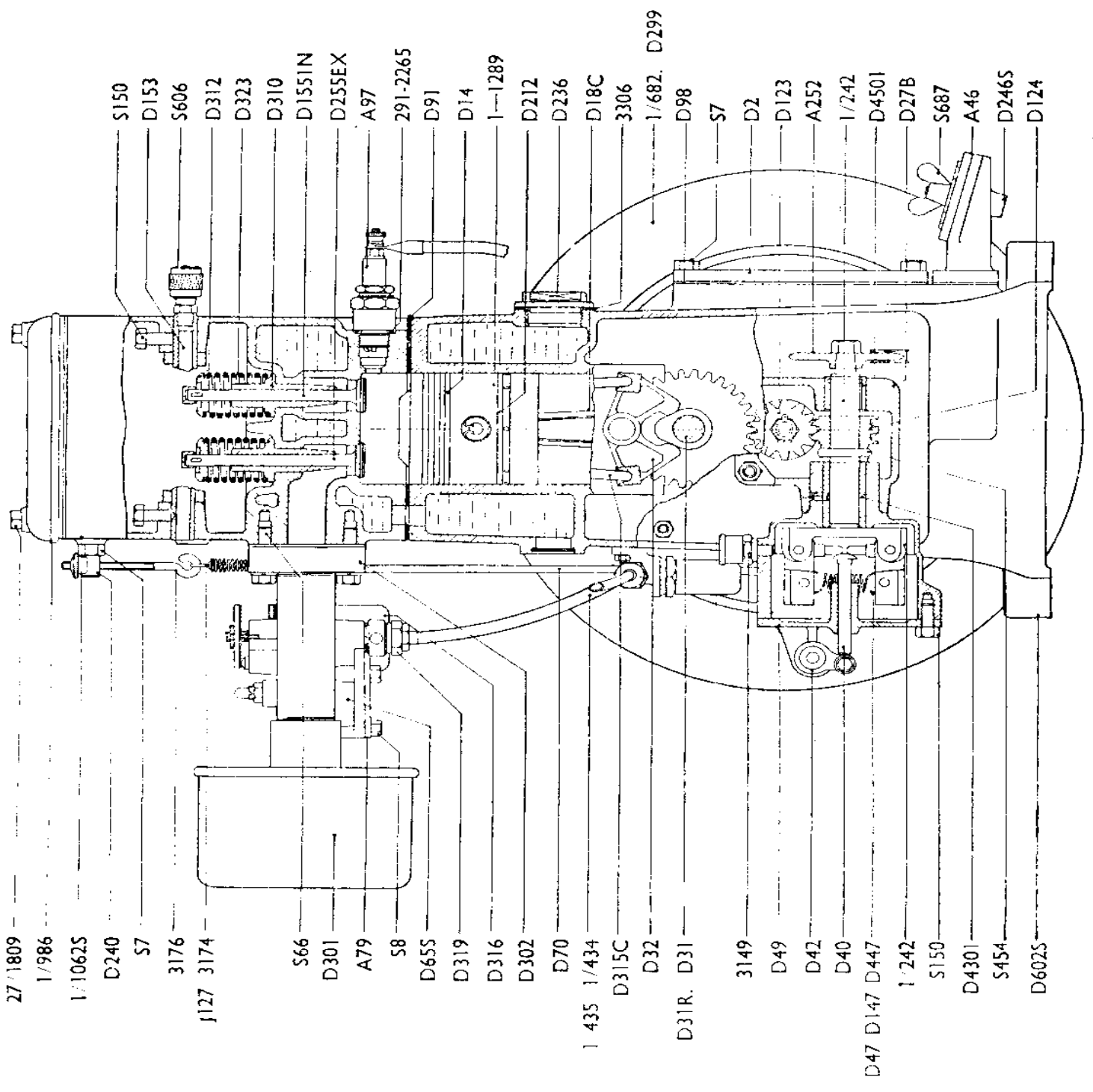

PLATE 3

	Order Part No.	No.		Order Part No.	No.
CAM ROCKER LEVERS					
Assembly complete	D32c	1	Oil Splash Guard Bolt (Case Door Side)	S1117	1
Inlet Rocker Lever	D22	1	Clamp	1/1246	1
Exhaust	D32	1	Plate	D604	1
Spindle for	D35	1	Crankcase Door	D2	1
Spring Washer for Spindle	S393	1	Joint	D98	1
Nut for Spindle	S6	1	Nut	S7	4
			Oil Drain Plug	S469	1
CRANKSHAFT (Comprising Shaft with Starting Clutch)					
Assembly complete for R.H. Starting Engines	D31c	1	Oil Filler with Stud for Petrol Engines	D246D	1
L.H.	D31Rc	1	" " " Paraffin	D246K	1
Camshaft bare	D31	1	Stud for Petrol Engines	S217	1
Starting Clutch for R.H. Starting Engines	D36	1	Paraffin	S217	1
L.H.	D234	1	Joint	D247	1
Taper Pin (No. 3) for Starting Clutch	S720	1	Nut	S7	2
" (No. 1)	S454	1	Lid	A46	1
Reamer for No. 1 Taper Pin	S751	1	Wing Nut	S687	1
No. 3	S753	1	Crankcase Drain Tap for water	D/610	1
			Joint Washer for Drain Tap	5197	1
			Crankcase Water Drain Tap Adaptor Joint	3306	1
			Drain Tap Adaptor Plug	D236	1
			Frost Plate	S161	1
CONNECTING ROD					
Connecting Rod complete comprising Bush (small end) specially drilled and reamed for spares	D18c	1	CRANKSHAFT		
" (big end)	D16	1	Crankshaft with Sleeve D33, Split Ring D30 on Crank Pin	D221	1
Dipper (long pattern)	D19	1	Crankshaft for 1 k.w. plant with Sleeve D33 Split Ring D30 on Crank Pin	D483	1
	D238	1	Oil Thrower Ring	D219	1
			" " Spring Ring	D220	1
CRANKCASE					
Crankcase with Studs, Oil Splash Guard and Oil Filler	D602c	1	" " Screw	S1127	1
Crankcase with Studs (Std.)	D602s	1	Ball Bearing, flywheel end (small)	D7	1
Stud for Timing Case	27/1961	8	" " crank pin end (large)	D8	1
" Main Bearing Housing	S37	5	Housing	D6	1
" Cylinder Head (long)	S529	2	Paper Joint	D87	1
" " (short)	S535	3	Nut	S7	5
" Inspection Door	S37	4	End Cover	D5	1
" Oil Filler	S37	2	Set Pin	S332	4
Oil Splash Guard (Clockwise)	D603	1	Driving Pin for Trailing Shaft	D28	1
" (Anti-clockwise)	D605	1	Crankshaft Sleeve	D33	1
" Bolt (Drain Plug Side)	S225	2	" Split Ring	D30	1

PLATE 3 (Continued) FOR ILLUSTRATION OF THESE PARTS REFER TO PAGE 11

	Order Part No.	No.
FLYWHEEL		
Flywheel 12" Dia. 2 H.P. Hopper or Tank Cooled	D299	1
" " " Radiator Cooled	F176	1
" " 13" Dia. 1½ H.P. Hopper or Tank Cooled	D1238	1
" " 14" Dia. 1½ H.P. with Coupling	1/682	1
Facings (for Direct Coupled Plant) and Radiator Cooled		
Flywheel Key	H75	1
GUDGEON PIN		
Gudgeon Pin	D15	1
" " Retaining Spring	D17	2
PISTON		
Piston, D type only (Standard)	1/1289	1
" DK " (Standard)	1/1290	1
" Ring (Standard)	D14	3
" Scraper Ring (Standard)	D212	1
PULLEY		
Pulley 3½" dia. x 5" Face	D71	1
" 4" dia. x 5" " "	D72	1
" 5" dia. x 4½" " Standard Size	D76	1
" 6" dia. x 4½" Face	D73	1
" 7" dia. x 6" " "	D175	1
" 8" dia. x 5" " "	D75	1
Set Screw for Pulleys, 5" dia. and over	S739	1
Grub Screw for 3½" and 4" dia. Pulleys only	10-8-88	1
Pulley Key	S353	1
TIMING CASE		
Complete (Comprising D31 Camshaft; D32C Cam, Rocker Assembly, D267 Governor Complete 700 r.p.m. or D268 Governor Complete 1000 r.p.m., Magneto and Starting Handle Bracket 1/741, D26C Trailing Shaft Complete) — For 500 R.P.M.	1/782	1
do. For 700 R.P.M.	1/761/5	1
do. For 1000 R.P.M.	1/762/5	1
Timing Case, with Studs and Bush	D27B	1
" " Joint	D90	1
Bush for Timing Case (Magneto Side)	1/4501	1
Oiling Plug	5-1/B6	1
" " Joint	5197	1
Plug for Oil Drain Hole	D52	1
Stud for Starting Handle Bracket	27/1583	4
TRAILING SHAFT		
Trailing Shaft complete with Spiral Gear	D26c	1
" " (with Drive Plate shrunk on only)	D26	1
Spiral Gear	D123	1
Key for Spiral Gear (Woodruff No. 6)	S566	1
Washer	S184	1
Slotted Nut	S241	1
Split Pin for Nut	S236	1



- 27/1809
- 1/986
- 1/1062S
- D240
- S7
- 3176
- J127 3174
- S66
- D301
- A79
- S8
- D655
- D319
- D316
- D302
- D70
- 1 435 1/434
- D315C
- D32
- D31R. D31
- 3149
- D49
- D42
- D40
- D47 D147 D447
- 1 242
- S150
- D4301
- S454
- D602S
- S150
- D153
- S606
- D312
- D323
- D310
- D1551N
- D255EX
- A97
- 291-2265
- D91
- D14
- 1-1289
- D212
- D236
- D18C
- 3306
- 1/682. D299
- D98
- S7
- D2
- D123
- A252
- 1/242
- D4501
- D27B
- S687
- A46
- D2465
- D124

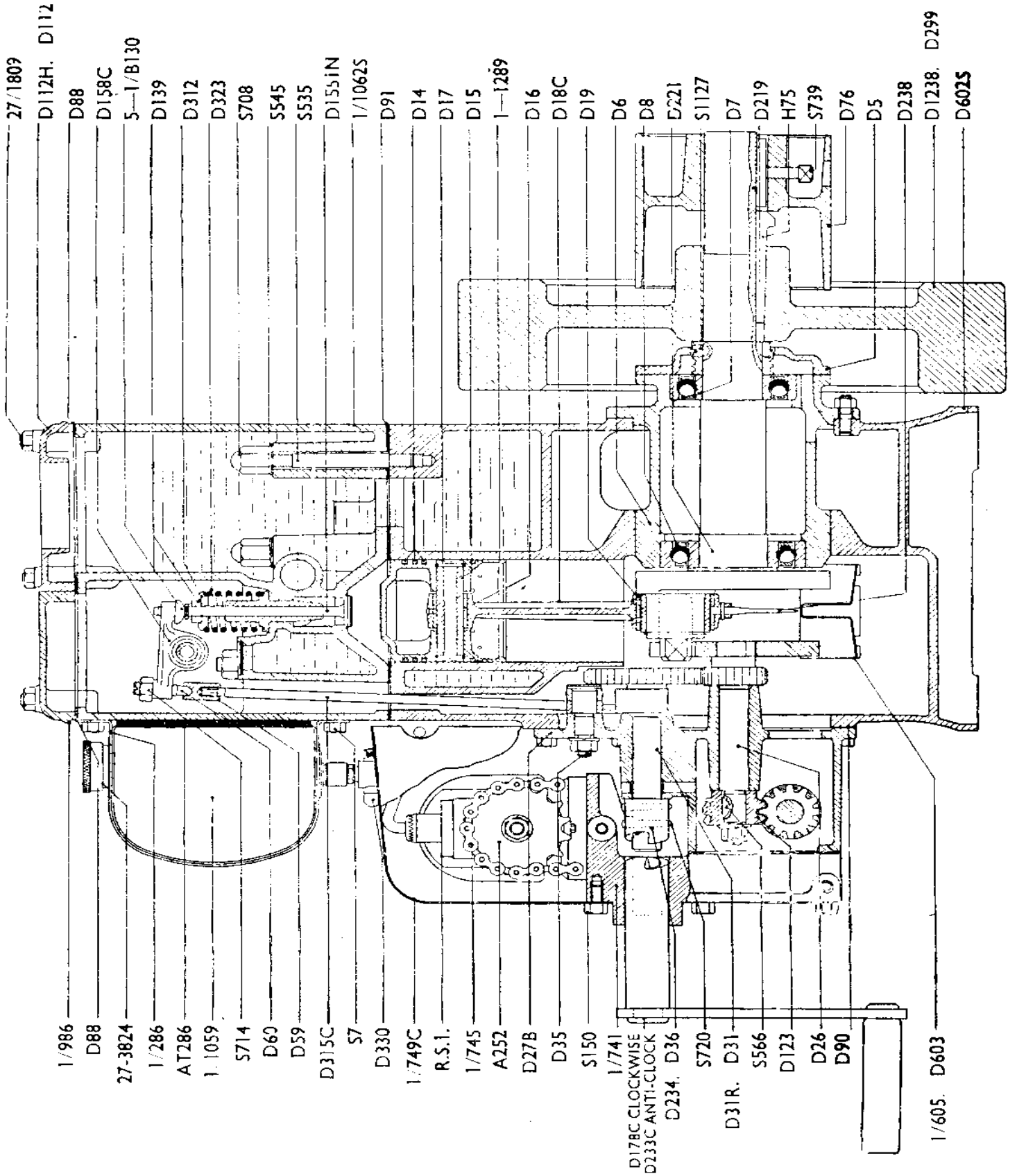

R. A. LISTER & CO. LTD.,
DURSLEY, GLOUCESTERSHIRE, ENGLAND

Telephone: Dursley 2371

Telegrams: Machinery, Dursley.

Bk. 68/152